

Indoor Sports Hall - Extract of the First Floor - 501B / Complete ground floor in drawing 462(0)PL 105

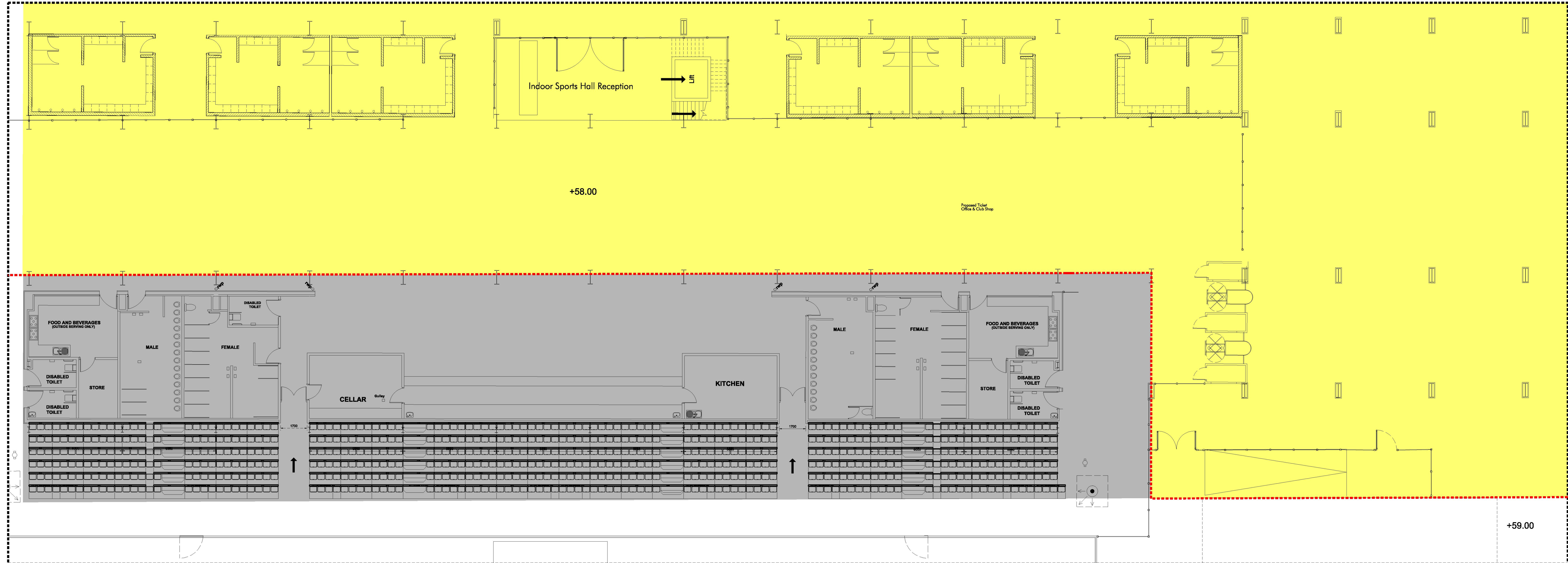

Indoor Sports Hall - Extract of the Ground Floor - 501A / Complete ground floor in drawing 462(0)PL 102

Approved Permission
Application Academy

A	10/10/17	Planning Issue	XB	BC
/	22/09/17	Planning Issue	XB	BC
rev	date	notes	drawn by	checked by
1:	Originator		2: Project Architect	3: Director
<input type="checkbox"/>				

PLANNING ISSUE

AndArchitects

16 Monkswellia Court, 142 Bethnal Park Road, London SW1 1 4NH
Tel: +4 4 (0) 20 7726 3999 Email: info@andarchitects.co.uk

client

Football First

project

The Hive - Indoor Academy & Sports Hall

drawing title

Proposed Ground and First Floors

project start date

July 2017

scale

1:100 @ A0

revision

1:200 @ A2

drawing number

A

462 PL(0)501

All dimensions must be checked on site and any discrepancies reported to the architect before any work commences. DO NOT SCALE from this drawing. The drawing is the property of AND Architects Ltd and may not be copied or printed without express written permission from AND Architects Ltd.